



LIFTING
EQUIPMENT
CATEGORY A

820-31074
PUBLICATION NO.

OBSOLETE: SOME PART MAY STILL BE AVAILABLE.

**REPAIR PARTS LIST
FOR
AIR-OPERATED ONE-END LIFT**

| BRAND NAME | CAPACITY | MODEL NUMBER |
|-------------------|-----------------|---------------------|
| BLACKHAWK | 5 Tons | 67440 |
| BLACKHAWK | 5 Tons | SJ-65 |

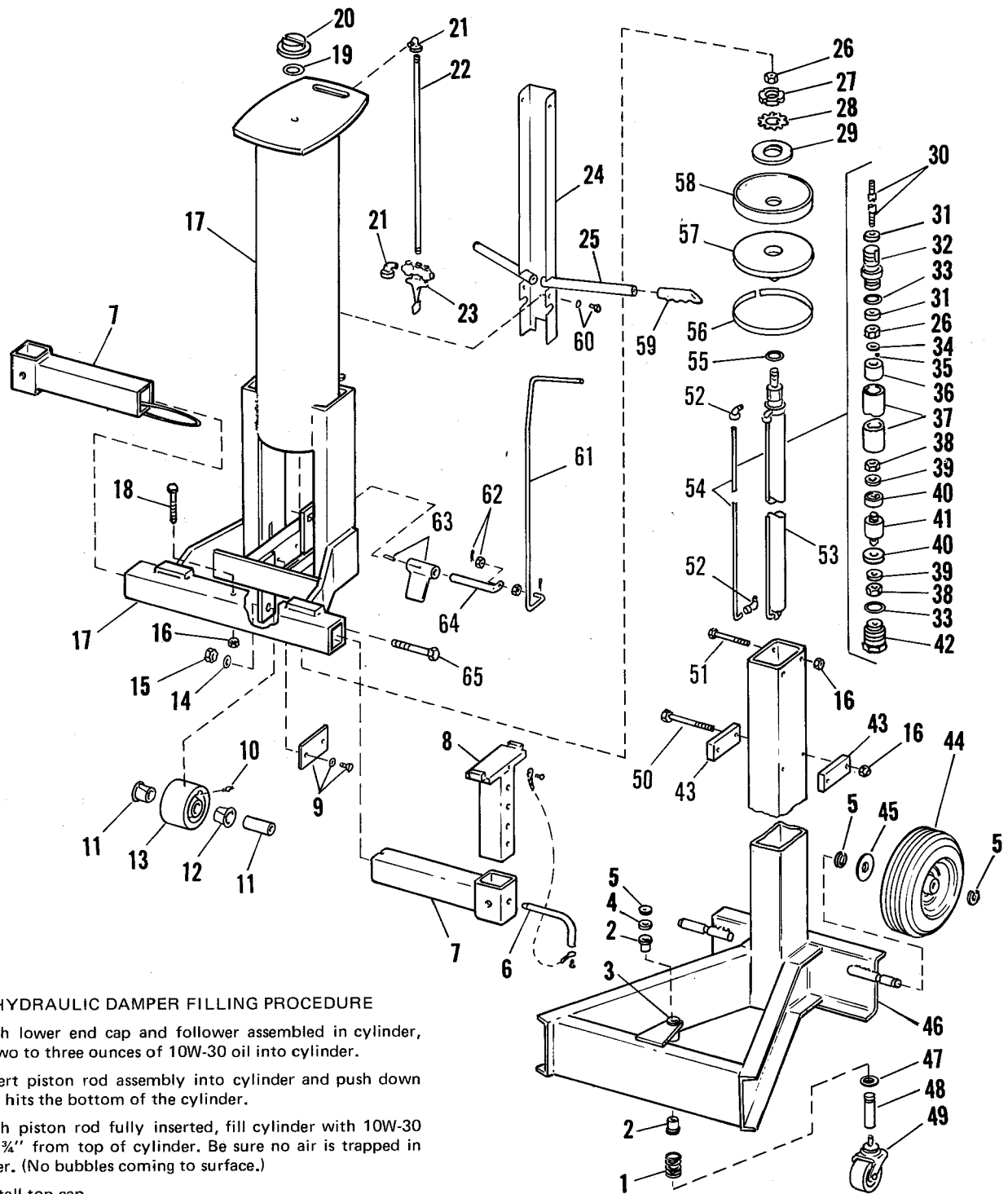

HYDRAULIC DAMPER FILLING PROCEDURE

1. With lower end cap and follower assembled in cylinder, pour two to three ounces of 10W-30 oil into cylinder.
2. Insert piston rod assembly into cylinder and push down until it hits the bottom of the cylinder.
3. With piston rod fully inserted, fill cylinder with 10W-30 oil to $\frac{3}{4}$ " from top of cylinder. Be sure no air is trapped in cylinder. (No bubbles coming to surface.)
4. Install top cap.
5. Pull on piston rod. There should be no free movement of the rod. Even a slight free movement indicates too low an oil level. Overfilling the cylinder will cause the piston rod to creep out of the cylinder by itself. If it does not come out by itself more than one-half inch, this condition is acceptable.
6. When installing tubing elbows to unit, make sure they are leak-free as a leak at the elbows and tube will result in leak-down of the jack.

| ITEM NO. | PART NO. | NO. REQ. | DESCRIPTION |
|----------|-----------|----------|----------------------|
| 1 | K12.110 | 1 | Spring |
| 2 | K220.039 | 2 | Bushing |
| 3 | K17.111 | 1 | Bracket |
| 4 | K122.108 | 1 | Washer |
| 5 | K289.044 | 5 | Ring |
| 6 | A489.900 | 2 | Pin w/Chain |
| 7 | K104.626 | 2 | Arm |
| 8 | K111.626 | 2 | Saddle |
| 9 | K225.186 | 2 | Spacer |
| | AJ100.207 | 4 | Bolt |
| | SJ100.415 | 4 | Washer |
| 10 | S4.188-2 | 1 | Fitting |
| 11 | K201.268 | 1 | Spacer |
| 12 | K200.039 | 2 | Bushing |
| 13 | K202.281 | 1 | Roller |
| 14 | K338.108 | 1 | Washer |
| 15 | K285.055 | 1 | Nut |
| 16 | C427.120 | 5 | Nut |
| 17 | K35.900 | 1 | Tank |
| 18 | K286.028 | 1 | Bolt |
| *19 | K288.041 | 1 | O-Ring |
| 20 | K224.020 | 1 | Cap, Top |
| 21 | J168.291 | 2 | Elbow |
| 22 | K203.096 | 1 | Pipe |
| 23 | K91.900 | 1 | Valve |
| 24 | K206.626 | 1 | Cover w/Handles |
| 25 | K205.070 | 2 | Handle |
| 26 | D235.055 | 2 | Nut |
| 27 | K222.055 | 1 | Nut |
| 28 | K230.108 | 1 | Washer |
| 29 | K223.108 | 1 | Washer |
| 30 | K124.149 | 1 | Rod |
| *31 | K125.041 | 2 | Cup |
| 32 | K131.020 | 1 | Cap |
| *33 | K106.041 | 2 | O-Ring |
| 34 | K105.108 | 1 | Washer |
| 35 | S4.156 | 1 | Ball |
| 36 | K128.051 | 1 | Piston |
| 37 | K127.030 | 1 | Cylinder |
| 38 | EJ100.014 | 2 | Nut |
| 39 | EJ100.012 | 2 | Washer |
| *40 | D385.041 | 2 | Cup |
| 41 | K129.071 | 1 | Follower |
| 42 | K130.020 | 1 | Cap |
| 43 | K118.101 | 2 | Plate |
| 44 | K119.106 | 2 | Wheel |
| 45 | E189.108 | 2 | Washer |
| 46 | K17.001 | 1 | Frame |
| 47 | K121.108 | 1 | Washer |
| 48 | K42.061 | 1 | Stem |
| 49 | E169.106 | 1 | Caster |
| 50 | K147.242 | 2 | Bolt |
| 51 | K287.028 | 2 | Bolt |
| 52 | J606.291 | 2 | Elbow |
| 53 | K132.900 | 1 | Damper, Hydraulic |
| 54 | K126.268 | 1 | Tube |
| *55 | J774.041 | 1 | O-Ring |
| 56 | K219.044 | 1 | Spacer |
| 57 | K218.626 | 1 | Piston |
| *58 | K221.041 | 1 | Cup |
| 59 | K567.550 | 2 | Grip |
| 60 | K6.028 | 4 | Bolt |
| | D256.108 | 4 | Washer |
| 61 | K214.149 | 1 | Rod, Release |
| 62 | W40.108 | 2 | Washer |
| | K18.58 | 2 | Pin |
| 63 | K213.626 | 1 | Latch |
| | B239.061 | 1 | Pin |
| 64 | K209.626 | 1 | Shaft |
| 65 | K284.028 | 1 | Bolt |
| † | K573.026 | 1 | Decal (Instructions) |
| † | E704.026 | 1 | Decal (Caution) |
| † | SJ65.026X | | Decal (Model) |

Items included in Kit are marked with asterisk (*)

For economical maintenance order Repair Kit 67440X

†Not Shown